

2CD-2CB



WŁAŚCIWOŚCI / FEATURES

Elektryczne pompy odśrodkowe monoblokowe z podwójnym wirnikiem, idealne do utrzymywania ciśnienia w domowych i przemysłowych instalacjach wodnych oraz małych i średnich systemach nawadniania.

Centrifugal two-impeller electric pumps, suitable for pressurizing civil and industrial booster plants and small-medium irrigations.

MATERIAŁY / MATERIALS

- Korpus pompy i uchwyt: żeliwo
- Wał: stal nierdzewna AISI 416 (Hp1)-AISI 303 (Hp1,5-Hp2-Hp3-Hp4-Hp5,5-Hp7,5) AISI 304 (Hp10-Hp12,5-Hp15)
- Wirnik: Noryl® model 2CD67P - 2CB73PT
- Mosiądz od modeli 2CD68N do 2CB90T
- *Pump body and motor bracket: cast iron*
- *Shaft: stainless steel: AISI 416 (Hp1) - AISI 303 (Hp1,5-Hp2-Hp3-Hp4-Hp5,5-Hp7,5) - AISI 304 (Hp10-Hp12,5-Hp15)*
- *Impeller: Noryl® model 2CD67P ÷ 2CB73PT*
- *Brass on models from 2CD68N to 2CB90T*

SILNIK / MOTOR

- Silnik zamknięty samo-wentylujący
- Stopień ochrony: IP44 - IP55 (2CB74T - 2CB77T)
- Klasa izolacji class F
- Zasilanie jednofazowe 230 V-50 Hz z zabezpieczeniem termicznym
- Zasilanie trójfazowe 230 V/400 V - 50 Hz do mocy 5,5 Hp, 400/690 V-50Hz od mocy 7,5 Hp
- *Self-ventilated closed motor*
- *Protection degree: IP44 - IP55 (2CB74T - 2CB77T)*
- *Insulation class F*
- *Single-phase feeding 230V-50Hz, with motor protection*
- *Three-phase feeding 230/400V-50Hz up to 5.5 HP, 400/690V-50Hz from 7.5 HP*

WARUNKI DZIAŁANIA / OPERATING CONDITIONS

- Model 2CD67P + 2CB73P: ciśnienie maksymalne 6 bar, maksymalna temperatura wody 50°C
- Model 2CD68N + 2CB77: ciśnienie maksymalne 11 bar, maksymalna temperatura wody 90°C
- *Mod. 2CD67P + 2CB73P: max pressure 6 bar, water temperature max 50°C*
- *Mod. 2CD68N + 2CB77: max pressure 11 bar, water temperature max 90°C*

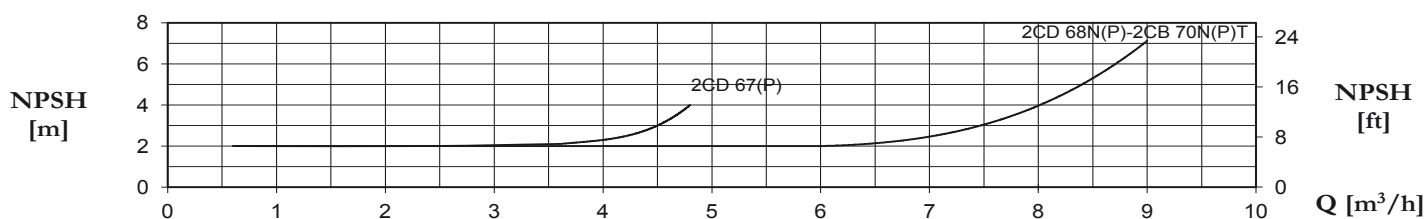
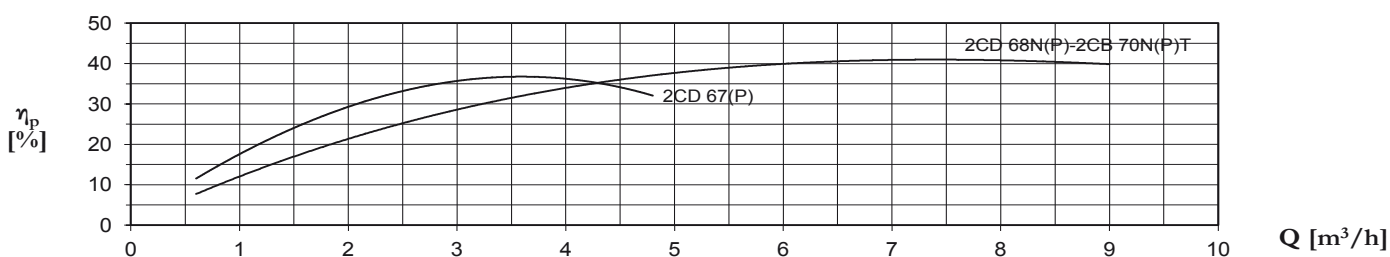
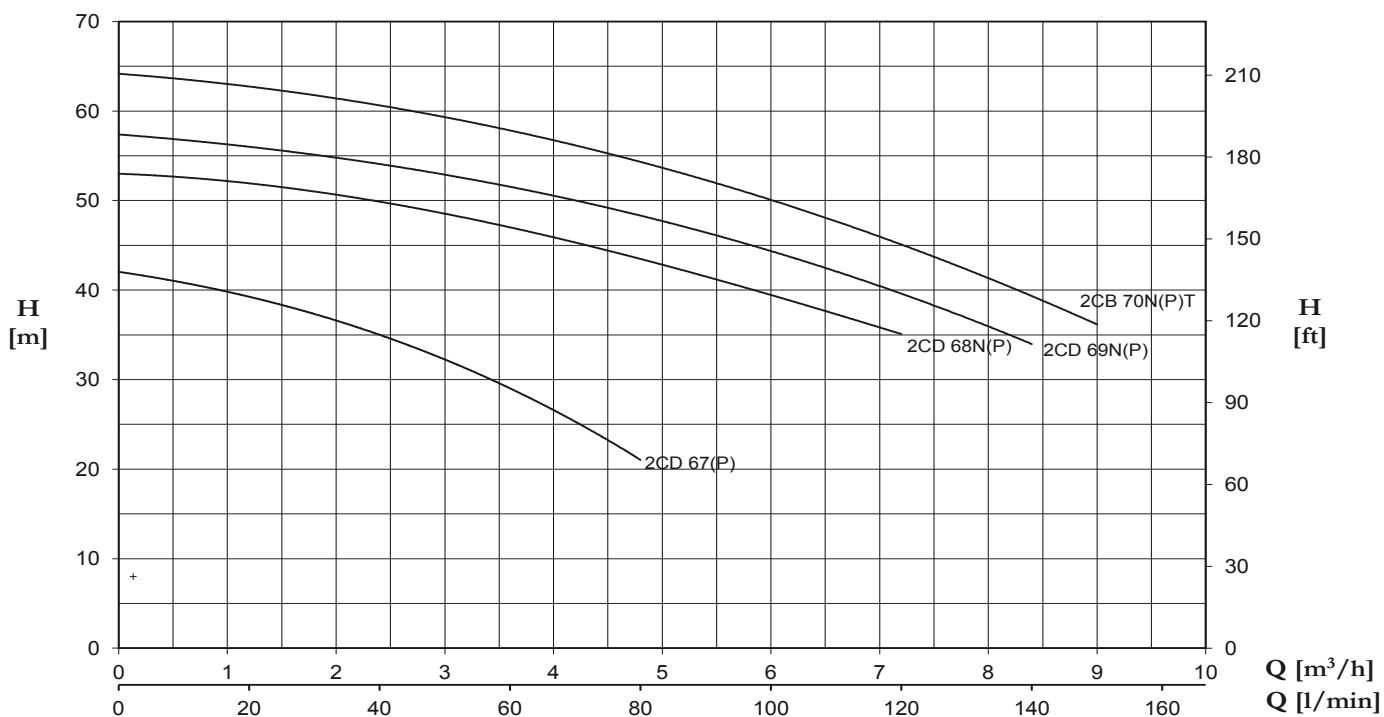

DANE TECHNICZNE PRZY 2900 OBR./MIN. / TECHNICAL PERFORMANCE AT 2900 RPM

| Model Model | | P2 | | A | | Q (m ³ /h - l/min) | | | | | | | | | | |
|----------------|-------------|-----|------|--------|--------|-------------------------------|------|------|------|------|------|------|------|------|------|-----|
| | | | | | | 0 | 0,6 | 1,2 | 1,8 | 2,4 | 3,6 | 4,8 | 6 | 7,2 | 8,4 | 9 |
| 1~ | 3~ | HP | kW | 1x230V | 3x400V | 0 | 10 | 20 | 30 | 40 | 60 | 80 | 100 | 120 | 140 | 150 |
| H (m) | | | | | | | | | | | | | | | | |
| 2CD 67(P) | 2CD 67(P)T | 1 | 0,74 | 5,4 | 2,4 | 42 | 40,8 | 39,4 | 37,4 | 34,7 | 29,2 | 21 | - | - | - | - |
| 2CD 68N(P) | 2CD 68N(P)T | 1,5 | 1,1 | 10,2 | 4,1 | 53 | 52,5 | 52 | 51 | 50 | 46,9 | 43,3 | 39,7 | 35 | - | - |
| 2CD 69N(P) | 2CD 69N(P)T | 2 | 1,5 | 11,5 | 4,8 | 57,3 | 56,9 | 56 | 55,1 | 54 | 51,5 | 48,4 | 44,4 | 39,5 | 34 | - |
| | 2CB 70N(P)T | 3 | 2,2 | 13,2 | 5,2 | 64 | 63,5 | 63 | 61,9 | 60,6 | 57,7 | 54,1 | 50 | 45,4 | 39,4 | 36 |

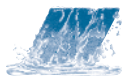

2CD-2CB

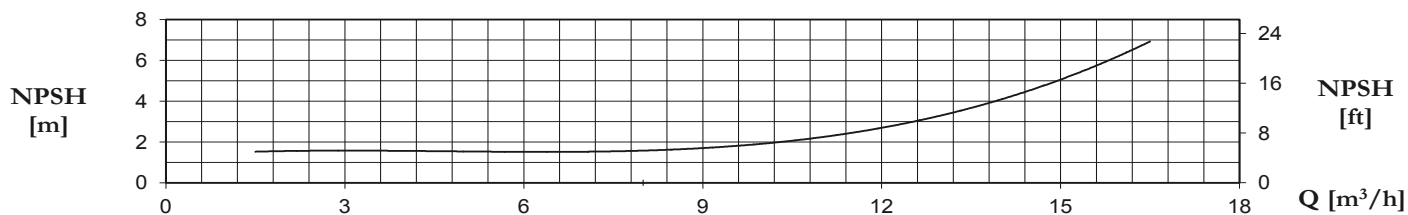
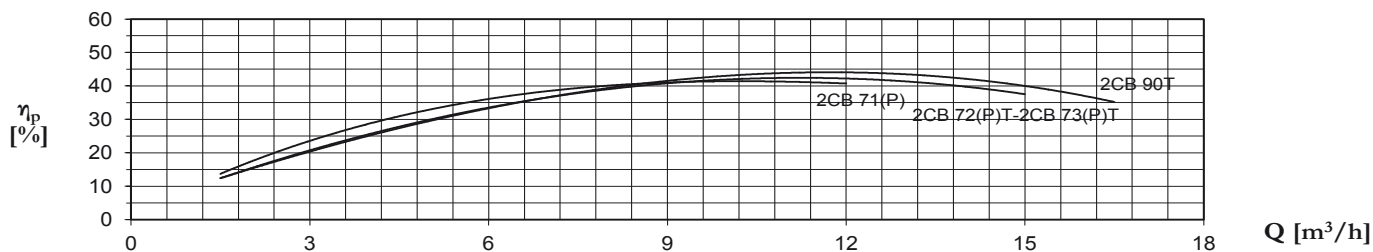
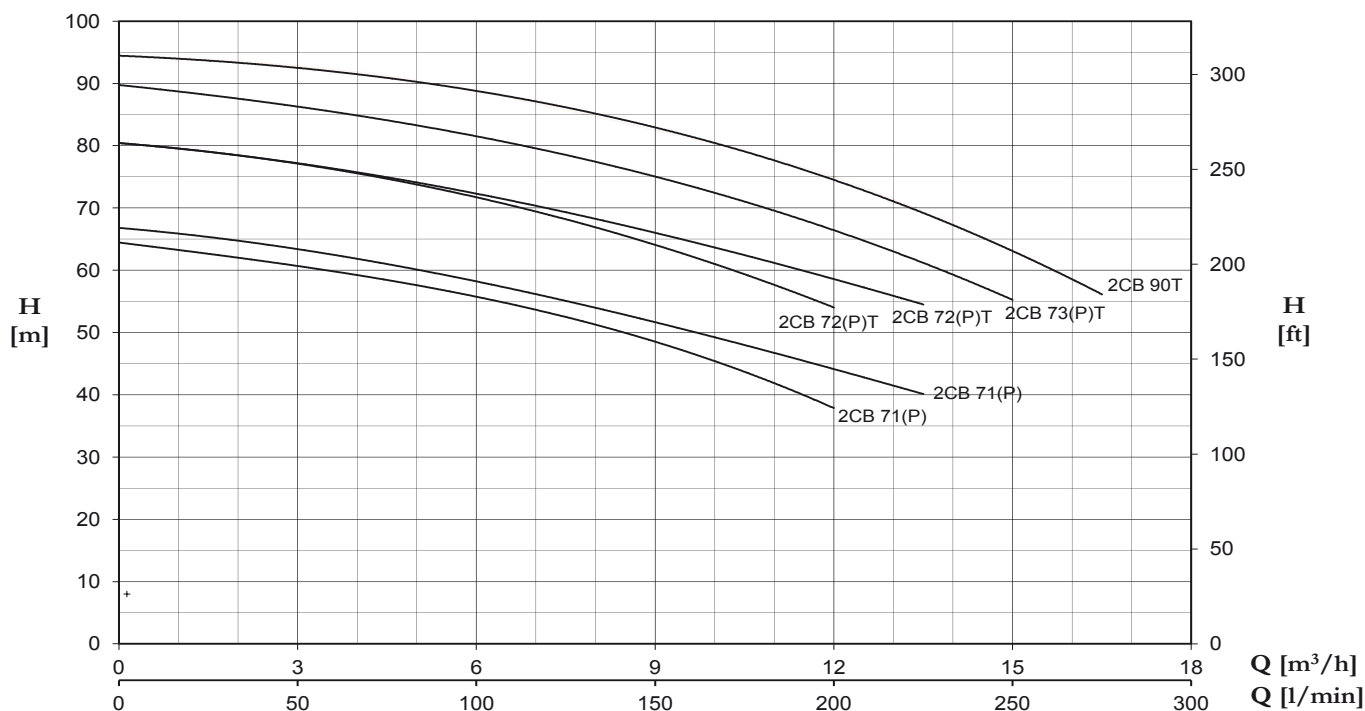

DANE TECHNICZNE PRZY 2900 OBR./MIN. / TECHNICAL PERFORMANCE AT 2900 RPM

| Model Model | | P2 | | A | | Q (m ³ /h - l/min) | | | | | | | | | | | |
|----------------|-------------|-----|-----|--------|--------|-------------------------------|------|------|------|------|------|------|------|------|------|------|------|
| | | | | | | 0 | 1,5 | 3,0 | 4,5 | 6,0 | 7,5 | 9,0 | 10,5 | 12 | 13,5 | 15,0 | 16,5 |
| 1~ | 3~ | HP | kW | 1x230V | 3x400V | 0 | 25 | 50 | 75 | 100 | 125 | 150 | 175 | 200 | 225 | 250 | 275 |
| | | | | | | H (m) | | | | | | | | | | | |
| 2CD 71(P) | | 4 | 3 | 19,0 | - | 64,4 | 62,7 | 60,8 | 58,3 | 55,6 | 52,6 | 48,7 | 43,5 | 37,9 | - | - | - |
| | 2CB 71(P)T | 4 | 3 | - | 7,9 | 66,9 | 65,2 | 63,3 | 61 | 58,4 | 55,2 | 51,5 | 47,8 | 44,3 | 40,1 | - | - |
| 2CD 72(P) | | 5,5 | 4,0 | 26,0 | - | 80,4 | 79,1 | 77,1 | 74,5 | 71,8 | 68,4 | 64 | 59,2 | 54,1 | - | - | - |
| | 2CB 72 (P)T | 5,5 | 4,0 | - | 9,8 | 80,4 | 79,1 | 77,1 | 75 | 72,2 | 69,4 | 66 | 62,4 | 58,6 | 54,5 | - | - |
| | 2CB 73 (P)T | 7,5 | 5,5 | - | 11,6 | 89,5 | 88,3 | 86,7 | 84,1 | 81,3 | 78,3 | 74,7 | 71,1 | 66,9 | 61,3 | 55 | - |
| | 2CB 90 (P)T | 9 | 6,6 | - | 13,2 | 94,2 | 93,8 | 92,8 | 91,2 | 88,7 | 85,7 | 82,5 | 79,1 | 75 | 69,4 | 63 | 56 |

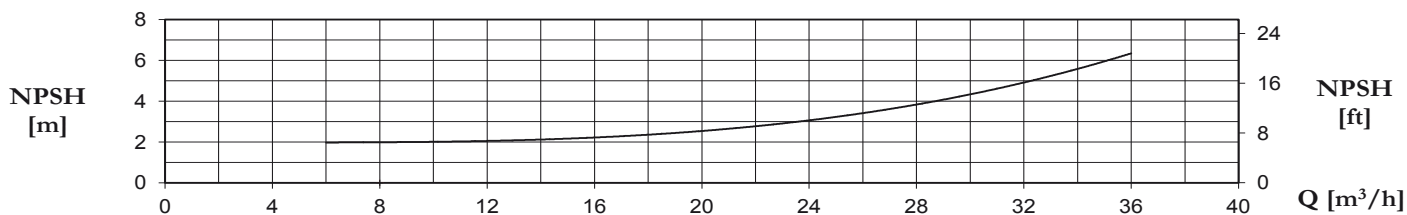
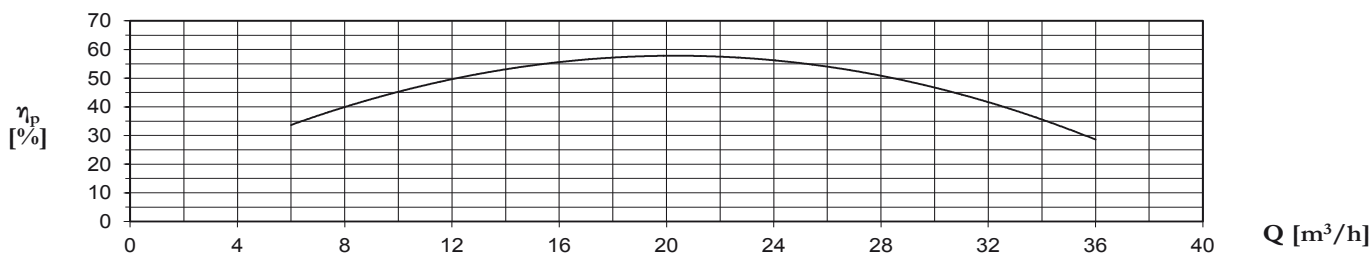
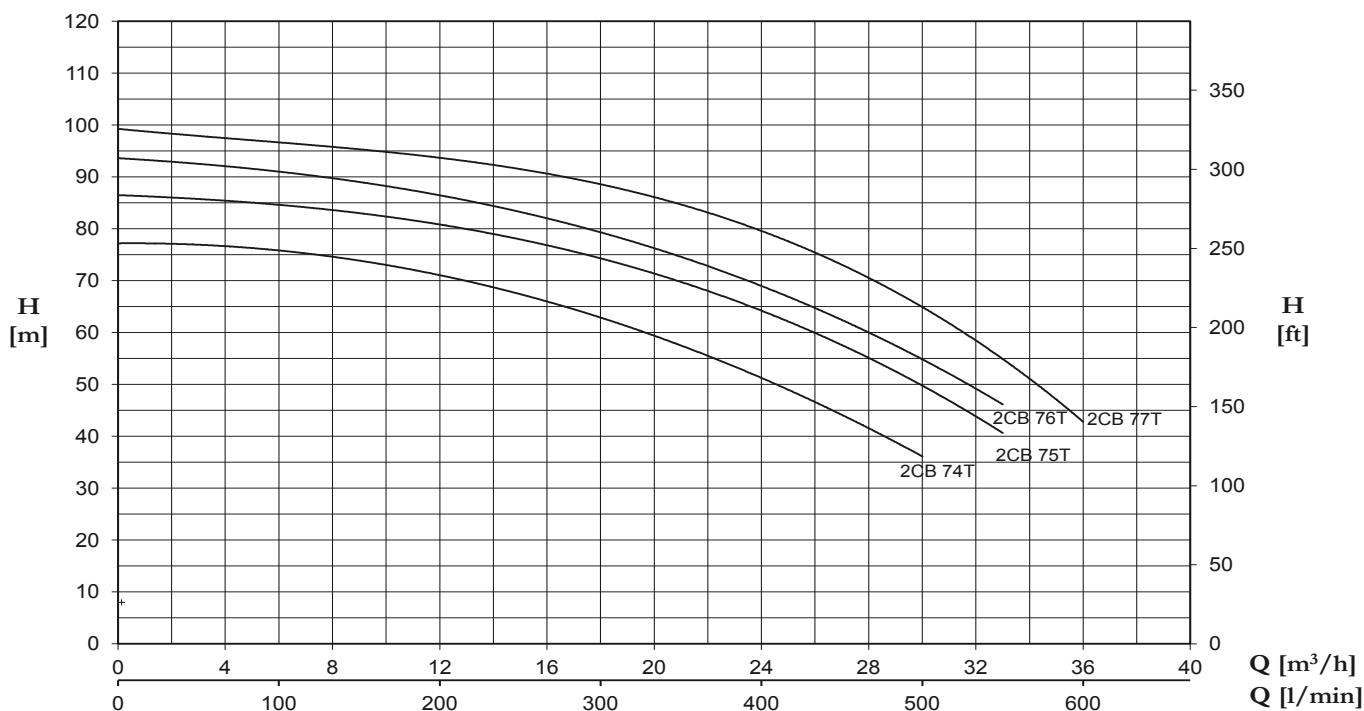
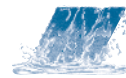

DANE TECHNICZNE PRZY 2900 OBR./MIN. / TECHNICAL PERFORMANCE AT 2900 RPM

| Model <i>Model</i> | P2 | | A | Q (m³/h - l/min) | | | | | | | |
|-----------------------|------|-----|--------|------------------|------|------|------|------|------|------|------|
| | | | | 0 | 6 | 12 | 18 | 24 | 30 | 33 | 36 |
| 3~ | HP | kW | 3x400V | 0 | 100 | 200 | 300 | 400 | 500 | 550 | 600 |
| | | | | H (m) | | | | | | | |
| 2CB 74T | 7,5 | 5,5 | 15 | 77,0 | 76,4 | 70,5 | 62,8 | 51,6 | 36,0 | - | - |
| 2CB 75T | 10 | 7,5 | 17,2 | 86,4 | 84,8 | 80,7 | 74,3 | 64,0 | 50,2 | 40,4 | - |
| 2CB 76T | 12,5 | 9,2 | 18,9 | 93,6 | 91,0 | 86,3 | 79,7 | 68,5 | 55,2 | 46,0 | - |
| 2CB 77T | 15 | 11 | 20,4 | 98,7 | 97,6 | 94,2 | 87,6 | 78,2 | 65,6 | 57,5 | 40,9 |

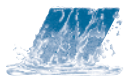

2CD-2CB

| MODEL POMPY <i>PUMP'S MODEL</i> | WYMIARY POMP mm <i>PUMP'S DIMENSIONS mm</i> | | | | | | | | | WYMIARY OPAKOWANIA mm <i>PACKING DIMENSIONS mm</i> | | | WAGA <i>WEIGHT</i> |
|------------------------------------|--|------|-----|-----|-----|-----|-----|----------|----------|---|-----|-----|-----------------------|
| | A | B | C | D | E | H1 | H2 | DNA | DNM | I | L | M | kg |
| 2CD 67(P) | 122 | 72 | 328 | 180 | 140 | 98 | 228 | 1"G | 1"G | 350 | 195 | 265 | 15,3 |
| 2CD 68N(P) | 115 | 82 | 385 | 210 | 170 | 110 | 265 | 1" 1/4 G | 1"G | 405 | 225 | 295 | 24,7 |
| 2CD 69N(P) | 115 | 82 | 385 | 210 | 170 | 110 | 265 | 1" 1/4 G | 1"G | 405 | 225 | 295 | 25,6 |
| 2CB 70N(P)T | 115 | 82 | 385 | 210 | 170 | 110 | 265 | 1" 1/4 G | 1"G | 405 | 225 | 295 | 25,6 |
| 2CB 71(P) | 145 | 95,5 | 463 | 266 | 212 | 135 | 305 | 1" 1/2 G | 1" 1/4 G | 500 | 275 | 350 | 41 |
| 2CB 72(P)T | 145 | 95,5 | 463 | 266 | 212 | 135 | 305 | 1" 1/2 G | 1" 1/4 G | 500 | 275 | 350 | 44,8 |
| 2CB 73(P)T | 145 | 95,5 | 480 | 266 | 212 | 135 | 305 | 1" 1/2 G | 1" 1/4 G | 500 | 275 | 350 | 50,5 |
| 2CB 90T | 145 | 95,5 | 480 | 266 | 212 | 135 | 305 | 1" 1/2 G | 1" 1/4 G | 500 | 275 | 350 | 55 |
| 2CB 74T | 190 | 120 | 605 | 275 | 210 | 150 | 330 | 2"G | 1" 1/4 G | 640 | 310 | 370 | 70,5 |
| 2CB 75T | 190 | 120 | 605 | 275 | 210 | 150 | 330 | 2"G | 1" 1/4 G | 640 | 310 | 370 | 77 |
| 2CB 76T | 190 | 120 | 645 | 275 | 210 | 150 | 330 | 2"G | 1" 1/4 G | 640 | 310 | 370 | 85 |
| 2CB 77T | 190 | 120 | 645 | 275 | 210 | 150 | 330 | 2"G | 1" 1/4 G | 640 | 310 | 370 | 92 |

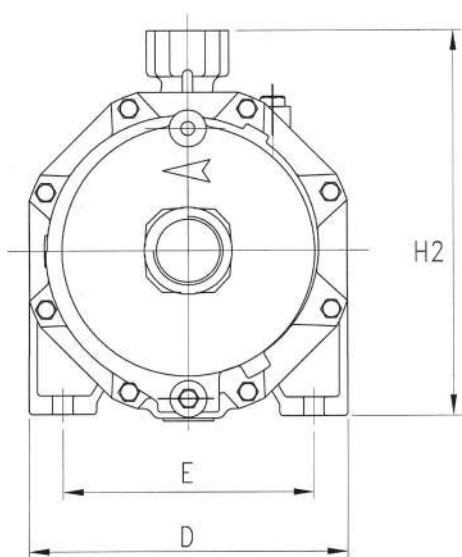
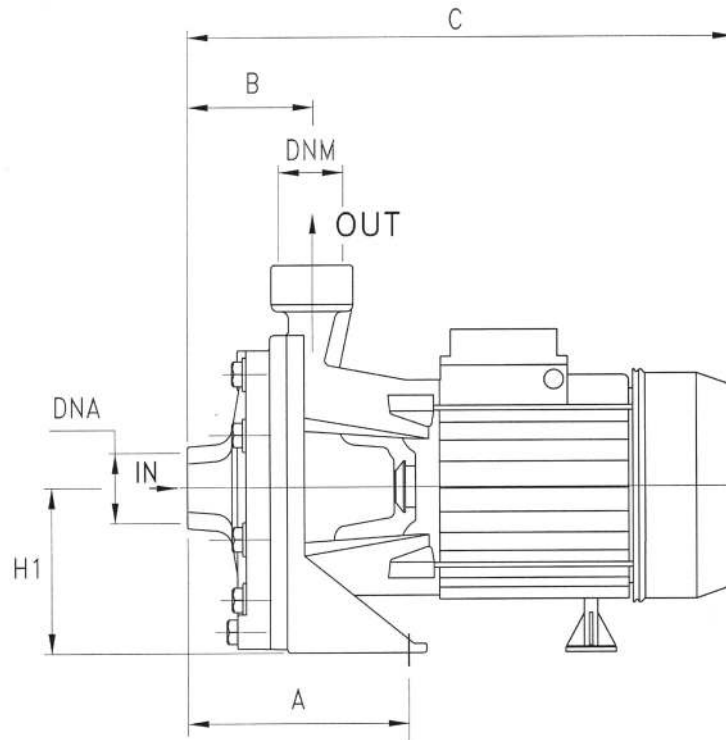
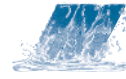

Wymiary opakowania
Packing dimensions

